



Diferencohemi
nëpërmjet
**cilësisë dhe
shërbimit.**



Albsteel...

Një emër i ri, por një trashëgimi vlerash & eksperience në tregun e metaleve në Shqipëri dhe më gjerë. Akumuluar dhe zgjedhur më të mirat në vite nga Papmetal, i cili është; ideatori, krijuesi dhe promovuesi i Albsteel.

Albsteel lindi si nevojë e promovimit të cilësisë së produkteve & shërbimit të Papmetal. Për këtë qëllim, në dispozicion të Albsteel është ndërtuar Qendra e Shërbimit të Metaleve, e vetmja në Shqipëri dhe më e madhja në rajon. Albsteel është një strukturë e posaçme, e cila synon të ri-dimensionojë standartet e shërbimit në tregun e metaleve në rajon.

15.000 meter katror sipërfaqe e mbyllur e mirë-organizuar në një sipërfaqe totale prej 50.000 meter katror. Kapacitetet i kalojnë 50.000 ton metale në vit.

Profilet tubolare prodhohen në fabrikën e Papmetal dhe ofrohen ekskluzivisht vetëm nga Qendra e Shërbimit të Metaleve Albsteel.

Formatet e ndryshme të lëvizshme të prodhuar në të ngrohtë dhe të ftohtë, galvanizuar dhe inox janë produkt i makinerive prodhim Italian, të pajisura me teknologjitë më të fundit në fushën e sheshimit dhe prerjes në gjatësi & gjerësi.

Me qëllim rritjen e standarteve të trajtimit të konstruksioneve metalike, ofrojmë shërbimin e pastrimit me rërë çeliku dhe lysterje me primer. Makineritë dhe teknologjia e përdorur është tërësisht Gjermane.

Standartet e administrimit, prodhimit dhe kontrollit të cilësisë janë në përputhje të plotë dhe të çertifikuara sipas Standarteve të Komunitetit Europian.

Albsteel është fytyra e qeshur & krenaria e Papmetal.





Zyrat qendrore në Xhafzotaj, Durrës

Profil tubular rrethor

Circular hollow section

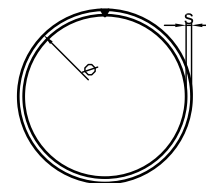

Φ (mm)	s (mm)	G (kg/m)	Φ (mm)	s (mm)	G (kg/m)	Φ (mm)	s (mm)	G (kg/m)	
18	1.0	0.45	42	1.2	1.24	76	1.5	2.80	
	1.2	0.53		1.5	1.54		2.0	3.71	
	1.5	0.65		2.0	2.04		2.5	4.61	
	2.0	0.84		2.5	2.53		3.0	5.51	
2.0	0.84	3.0		2.99	4.0		7.26		
20.5	1.0	0.51	44.5	1.2	1.32	89	5.0	8.99	
	1.2	0.61		1.5	1.64		2.0	4.35	
	1.5	0.74		2.0	2.15		2.5	5.42	
2.0	0.96	2.5		2.69	3.0		6.46		
21.5	1.0	0.54	3.0	3.18	95.5		4.0	8.54	
	1.2	0.64	48	1.2		1.42	5.0	10.60	
	1.5	0.78		1.5		1.77	102	2.0	5.00
	2.0	1.02		2.0		2.33		2.5	6.23
25.4	1.0	0.64		2.5		2.89		3.0	7.43
	1.2	0.76	3.0	3.42	4.0	9.82			
	1.5	0.94	4.0	4.50	5.0	12.16			
	2.0	1.23	51	1.2	1.52	114.5	2.5	6.96	
	2.5	1.50		1.5	1.87		3.0	8.34	
28.5	1.0	0.71		2.0	2.48		4.0	11.02	
	1.2	0.85		2.5	3.08		5.0	13.66	
	1.5	1.05	3.0	3.65	127		2.5	7.78	
	2.0	1.37	4.0	4.80		3.0	9.28		
	2.5	1.67	57	1.2		1.69	4.0	12.30	
32	1.0	0.81		1.5	2.10	152	5.0	15.31	
	1.2	0.95		2.0	2.76		3.0	11.14	
	1.5	1.19		2.5	3.43		4.0	14.76	
	2.0	1.55	3.0	4.08	5.0		18.37		
	2.5	1.90	4.0	5.38	160		3.0	11.75	
38	1.0	0.95	60	1.2		1.79	4.0	15.57	
	1.2	1.13		1.5		2.22	5.0	19.35	
	1.5	1.40		2.0		2.94	63.5	1.5	2.35
	2.0	1.84		2.5		3.65		2.0	3.10
	2.5	2.28	3.0	4.34	2.5	3.85			
40	1.2	1.19	4.0	5.72	3.0	4.57			
	1.5	1.47	63.5	1.5	2.35	4.0		6.03	
	2.0	1.93		2.0	3.10	2.5	3.85		
	2.5	2.40		2.5	3.65	3.0	4.57		
	3.0	2.83		3.0	4.34	4.0	6.03		

Profil tubular katror

Square hollow section

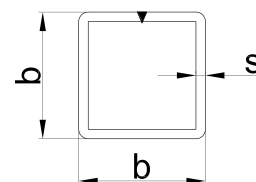

bxh (mm)	s (mm)	G (kg/m)	bxh (mm)	s (mm)	G (kg/m)
16 x 16	1.0	0.51	70 x 70	2.0	4.35
	1.2	0.61		2.5	5.42
	1.5	0.74		3.0	6.46
20 x 20	1.0	0.64		4.0	8.54
	1.2	0.76		5.0	10.6
	1.5	0.94	80 x 80	2.0	5.00
	2.0	1.23		2.5	6.23
2.5	1.50	3.0		7.43	
25 x 25	1.0	0.81		4.0	9.82
	1.2	0.95		5.0	12.17
	1.5	1.19	90 x 90	2.0	5.60
	2.0	1.55		2.5	6.96
	2.5	1.90		3.0	8.34
30 x 30	1.0	0.95		4.0	11.02
	1.2	1.13		5.0	13.66
	1.5	1.40	100 x 100	2.0	6.24
	2.0	1.84		2.5	7.78
	2.5	2.28		3.0	9.28
	3.0	2.69		4.0	12.3
40 x 40	1.0	1.28		5.0	15.31
	1.2	1.52	120 x 120	2.5	9.32
	1.5	1.87		3.0	11.14
	2.0	2.48		4.0	14.76
	2.5	3.08		5.0	18.37
	3.0	3.65		50 x 50	1.5
	4.0	4.80	2.0		3.10
60 x 60	2.0	3.71	2.5		3.85
	2.5	4.61	3.0		4.57
	3.0	5.51	4.0	6.03	
	4.0	7.26	70 x 70	2.0	4.35
	5.0	8.99		2.5	5.42

Profil tubolar drejtkëndor

Rectangular hollow section

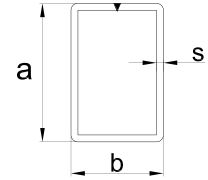

a x b (mm)	s (mm)	G (kg/m)	a x b (mm)	s (mm)	G (kg/m)	a x b (mm)	s (mm)	G (kg/m)
20 x 10	1.0	0.52	50 x 25	1.0	1.19	80 x 60	2.0	4.35
	1.2	0.62		1.2	1.42		2.5	5.42
	1.5	0.68		1.5	1.77		3.0	6.46
20 x 14	1.0	0.54		2.0	2.33		4.0	8.54
	1.2	0.64		2.5	2.89	100 x 20	1.2	2.25
	1.5	0.78	50 x 30	1.2	1.52		1.5	2.80
25 x 15	1.0	0.64		1.5	1.87		2.0	3.71
	1.2	0.76		2.0	2.48	100 x 40	2.0	4.35
	1.5	0.94		2.5	3.08		2.5	5.42
30 x 10	1.0	0.64		3.0	3.65		3.0	6.46
	1.2	0.76	50 x 40	1.2	1.69		4.0	8.54
	1.5	0.94		1.5	2.10	100 x 50	2.0	4.68
30 x 15	1.0	0.71		2.0	2.76		2.5	5.83
	1.2	0.85		2.5	3.43		3.0	6.95
	1.5	1.05		3.0	4.08		4.0	9.17
30 x 20	1.0	0.81	60 x 20	1.2	1.52	100 x 60	2.0	5.00
	1.2	0.96		1.5	1.87		2.5	6.23
	1.5	1.19		2.0	2.48		3.0	7.43
	2.0	1.55	60 x 30	1.5	2.10		4.0	9.82
	2.5	1.90		2.0	2.76		5.0	12.16
40 x 10	1.0	0.81		2.5	3.43	100 x 80	2.0	5.60
	1.2	0.95		3.0	4.08		2.5	6.96
	1.5	1.19	60 x 40	1.5	2.35		3.0	8.34
40 x 20	1.0	0.95		2.0	3.10		4.0	11.02
	1.2	1.13		2.5	3.85		5.0	13.66
	1.5	1.40		3.0	4.57	120 x 40	2.0	5.00
	2.0	1.84		4.0	6.03		2.5	6.23
	2.5	2.28	70 x 20	1.2	1.69		3.0	7.43
40 x 30	1.0	1.11		1.5	2.10		4.0	9.82
	1.2	1.32		2.0	2.76	120 x 60	2.5	6.96
	1.5	1.64	70 x 30	1.5	2.35		3.0	8.34
	2.0	2.15		2.0	3.10		4.0	11.02
	2.5	2.69		2.5	3.85		5.0	13.66
50 x 10	1.0	0.95	80 x 20	1.2	1.89	120 x 80	2.5	7.78
	1.2	1.13		1.5	2.35		3.0	9.28
	1.5	1.40		2.0	3.10		4.0	12.30
50 x 20	1.0	1.11	80x40	1.5	2.80		5.0	15.31
	1.2	1.32		2.0	3.71	150 x 100	3.0	11.75
	1.5	1.64		2.5	4.61		4.0	15.57
	2.0	2.15		3.0	5.51		5.0	19.35
				4.0	7.26			

Profile tubolare special

Custom Profiles

Profil tubolar sinjalistikë rrugore	s (mm)	G (kg/m)
60	1.5	2.35
	2.0	3.10
	2.5	3.85
	3.0	4.57

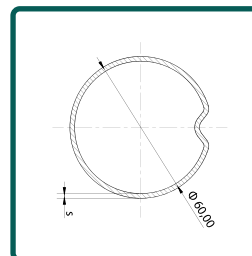

Profil tubolar gjysëm cilindrik dekorativ	s (mm)	G (kg/m)
52 x 26	1	1.10
	1.2	1.32
	1.5	1.64

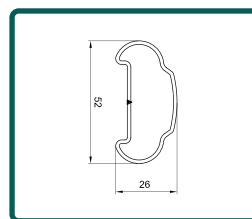

Profil tubolar gjysëm cilindrik	s (mm)	G (kg/m)
51 x 25.5	1	1.04
	1.2	1.24
	1.5	1.54
	2	2.04

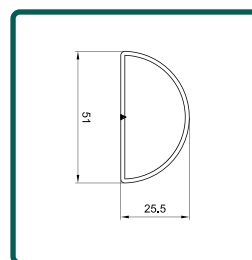

Profil tubolar oval	s (mm)	G (kg/m)
30 x 15	1	0.64
	1.2	0.76
	1.5	0.94

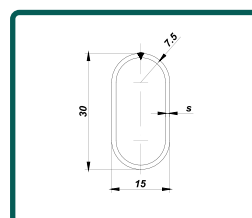

Profil tubolar gjysëm oval	s (mm)	G (kg/m)
50 x 25	1	1.27
	1.2	1.52
	1.5	1.87

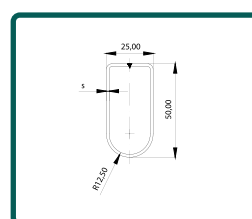

Profil tubolar L	s (mm)	G (kg/m)
38 x 25	1	1.19
	1.2	1.42
	1.5	1.77

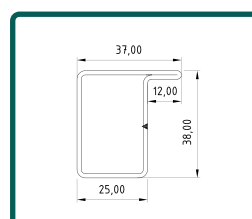

Profil tubolar T	s (mm)	G (kg/m)
38 x 25	1	1.40
	1.2	1.69
	1.5	2.10

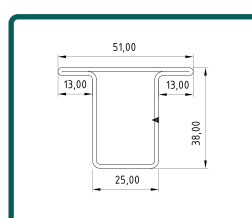

Llamarinë tabak

Steel sheet & plate

Spesori (mm)	1000 x 2000	1250 x 2200	1250 x 2500	1250 x 3000
0.40	6.3	8.6	9.8	11.8
0.45	7.1	9.7	11.0	13.2
0.50	7.9	10.8	12.3	14.7
0.55	8.6	11.9	13.5	16.2
0.60	9.4	13.0	14.7	17.7
0.70	11.0	15.1	17.2	20.6
0.75	11.8	16.2	18.4	22.1
0.80	12.6	17.3	19.6	23.6
0.90	14.1	19.4	22.1	26.5
1.00	15.7	21.6	24.5	29.4
1.10	17.3	23.7	27.0	32.4
1.20	18.8	25.9	29.4	35.3
1.35	21.2	29.1	33.1	39.7
1.50	23.6	32.4	36.8	44.2
1.80	28.3	38.9	44.2	53.0
2.00	31.4	43.2	49.1	58.9
2.50	39.3	54.0	61.3	73.6
2.80	44.0	60.4	68.7	82.4
3.00	47.1	64.8	73.6	88.3

Spesori (mm)	1000 x 2000	1500 x 6000	2000 x 6000	2000 x 8000
4	63	283	377	
5	79	353	471	
6	94	424	565	754
7	110	495	659	879
8	126	565	754	1005
9	141	636	848	1130
10	157	707	942	1256
12		848	1130	1507
14		989	1319	1758
15		1060	1413	1884
16		1130	1507	2010
18		1272	1696	2261
20		1413	1884	2512
22		1554	2072	2763
25		1766	2355	3140
28			2638	3517
30			2826	3768
35			3297	4396
40			3768	5024
50			4710	6280

Llamarine e riguar pikë loti

Chequered plates Teardrop Pattern

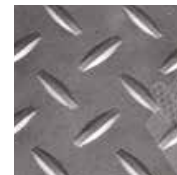

mm	1000 x 2000	1250 x 2500	1500 x 3000
1.5	27.55		
1.8	32.26	50.41	
2.0	35.40	55.31	79.65
2.5	43.25	67.58	97.31
3.0	51.10	79.84	114.98
4.0	66.80	104.38	150.30
5.0	82.50	128.91	185.63
6.0	98.20	153.44	220.95
8.0	129.60	202.50	291.60

Llamarine e riguar bakllava

Chequered Plates Diamond Pattern

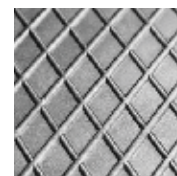

mm	1000 x 2000	1250 x 2500	1500 x 3000
1.5	31.55		
1.8	36.26	56.66	
2.0	39.40	61.56	88.65
2.5	47.25	73.83	106.31
3.0	55.10	86.09	123.98
4.0	70.80	110.63	159.30
5.0	86.50	135.16	194.63
6.0	102.20	159.69	229.95
8.0	133.60	208.75	300.60

Profil çeliku katror

Square bars

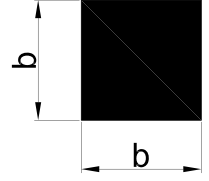

b (mm)	G (kg/m)	b (mm)	G (kg/m)
6	0.28	35	9.62
8	0.50	40	12.60
10	0.79	45	15.90
12	1.13	50	19.60
14	1.54	55	23.70
16	2.01	60	28.30
18	2.54	65	33.20
20	3.14	70	38.50
22	3.80	80	50.20
25	4.91	90	63.60
28	6.15	100	78.50
30	7.07	120	113.00
32	8.04	150	177.00

Profil çeliku rrethor

Round bars

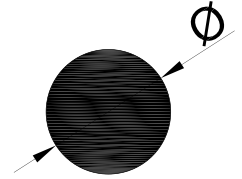

Φ (mm)	G (kg/m)	Φ (mm)	G (kg/m)
6	0.22	45	12.50
8	0.39	50	15.40
10	0.62	55	18.70
12	0.89	60	22.20
14	1.21	65	26.00
16	1.58	70	30.20
18	2.00	75	34.70
20	2.47	80	39.50
22	2.98	85	44.50
25	3.85	90	49.90
28	4.83	95	55.60
30	5.55	100	61.70
32	6.31	120	88.80
35	7.55	150	139.00
40	9.86	200	247.00

Profil çeliku lama

Flat bars

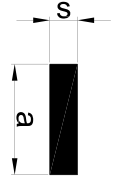

Width Gjërësia a (mm)	Spesori / Thickness													
	3	4	5	6	8	10	12	14	16	20	25	30	40	50
12	0.28	0.38	0.47	0.57	0.75									
14	0.33	0.44	0.55	0.66	0.88									
16	0.38	0.50	0.63	0.75	1.00	1.26								
20	0.47	0.63	0.79	0.94	1.26	1.57	1.88							
25	0.59	0.79	0.98	1.18	1.57	1.96	2.36	2.75						
30	0.71	0.94	1.18	1.41	1.88	2.36	2.83	3.30	3.77	4.71				
35	0.82	1.10	1.37	1.65	2.20	2.75	3.30	3.85	4.40	5.50				
40	0.94	1.26	1.57	1.88	2.51	3.14	3.77	4.40	5.02	6.28	7.85	9.42		
45	1.06	1.41	1.77	2.12	2.82	3.53	4.24	4.95	5.65	7.07	8.83	10.60		
50	1.18	1.58	1.96	2.36	3.14	3.93	4.71	5.50	6.28	7.85	9.81	11.80		
60	1.41	1.88	2.36	2.83	3.77	4.71	5.65	6.59	7.54	9.42	11.80	14.13	18.84	
70	1.64	2.20	2.75	3.30	4.40	5.50	6.59	7.69	8.79	11.00	13.73	16.50	22.00	
80	1.89	2.51	3.14	3.77	5.02	6.28	7.54	8.79	10.04	12.60	15.70	18.84	25.02	
90	2.12	2.82	3.53	4.24	5.65	7.07	8.48	9.89	11.30	14.13	17.70	21.19	28.26	
100	2.36	3.14	3.93	4.71	6.28	7.85	9.42	10.99	12.60	15.70	19.62	23.60	31.14	39.30
120	2.83	3.77	4.72	5.65	7.54	9.42	11.30	13.12	15.10	18.84	23.60	28.30	37.68	47.14
130	3.06	4.08	5.10	6.12	8.16	10.20	12.24	14.22	16.32	20.41	25.51	30.61	40.82	51.02
140	3.30	4.40	5.50	6.59	8.79	11.00	13.18	15.38	17.60	22.00	27.50	33.00	44.00	55.00
150	3.53	4.71	5.88	7.06	9.42	11.80	14.13	16.48	18.84	23.60	29.43	35.32	47.20	58.92

Profil çeliku ele barabrinjëse

Equal Angles bars

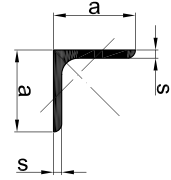

a (mm)	s (mm)	G (kg/m)	a (mm)	s (mm)	G (kg/m)
20	3	0.88	70	6	6.38
	4	1.14		7	7.38
25	3	1.12	8	8.36	
	4	1.45	75	7	7.94
30	3	1.36	8	8.92	
	4	1.77	80	7	8.49
35	5	2.18	8	9.66	
	3	1.61	10	11.90	
40	4	2.10	90	8	10.90
	3	1.86	9	12.20	
45	4	2.42	10	13.40	
	5	2.97	100	8	12.20
50	3	2.09	10	15.10	
	4	2.74	12	17.80	
55	5	3.38	110	10	16.60
	3	2.33	12	19.70	
60	4	3.06	120	10	18.20
	5	3.77	12	21.60	
65	6	4.47	15	26.60	
	8	5.82	140	14	29.50
70	4	3.33	150	10	23.00
	5	4.18	12	27.30	
75	4	3.70	15	33.80	
	5	4.57	18	40.10	
80	6	5.42	180	15	40.90
	8	7.09	16	43.50	
85	5	4.91	18	48.60	
	6	5.91	200	16	48.50
90	7	6.76	18	54.30	
	8	7.73	20	59.90	

Profil çeliku ele jo barabrinjëse

Unequal Angles bars

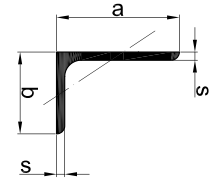

a (mm)	b (mm)	s (mm)	G (kg/m)
40	20	3	1.35
		4	1.77
45	30	5	2.37
50	30	4	2.41
		5	2.96
60	40	5	3.76
		6	4.46
65	50	7	5.97
75	55	5	4.95
		7	6.80
80	40	6	5.41
80	65	6	
		8	8.66
90	60	6	6.82
		8	8.96
100	50	6	6.85
		8	8.99
		10	11.10
100	65	7	8.77
		8	9.94
		9	11.10
100	75	8	10.50
		9	11.80
		10	13.05
120	80	8	12.20
		10	15.00
		12	17.80

a (mm)	b (mm)	s (mm)	G (kg/m)
125	75	8	12.20
		10	15.00
		12	17.80
130	65	8	11.90
		10	14.60
		12	17.30
130	90	10	16.60
		12	19.70
150	75	10	16.95
		12	20.30
150	90	10	18.60
		12	21.60
150	100	10	19.00
		12	22.60
180	90	10	20.60
		12	24.50
200	100	10	23.00
		12	27.30
		14	31.30
200	150	12	32.00
		15	39.90
250	90	10	26.10
		12	31.10
		14	36.00

Profil çeliku T

T-i bars

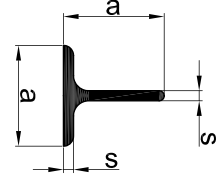

h=a (mm)	s (mm)	G (kg/m)	h=a (mm)	s (mm)	G (kg/m)
20	3.0	0.88	45	5.0	3.35
25	3.0	1.11	50	5.0	3.75
30	3.0	1.34	50	6.0	4.45
30	4.0	1.77	60	7.0	6.23
35	4.0	2.08	70	8.0	8.32
35	4.5	2.33	80	9.0	10.70
40	4.0	2.40	90	10.0	13.40
40	5.0	2.96	100	11.0	16.40

Trare çeliku UPN

UPN beams

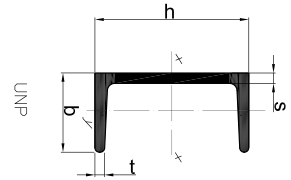

UPN	Weight (kg/m)	Dimensions (mm)				Section F	Resistance Moment (cm ³)	
		b	h	s	t	cm ²	W _x	W _y
UPN 30 x 15	1,74	15	30	4,0	4,5	2,21	1,69	0,39
UPN 40x20	2,86	20	40	5,0	5,5	3,7	3,79	0,86
UPN 40	4,87	35	40	5,0	3,5	6,2	7,05	3,08
UPN 50 x 25	3,86	25	50	5,0	6,0	4,92	6,73	1,48
UPN 50	5,59	38	50	5,0	7,0	7,12	10,6	3,75
UPN 60	5,07	30	60	6,0	6,0	6,46	10,5	2,16
UPN 65	7,09	42	65	5,5	7,5	9,03	17,7	5,07
UPN 80	8,64	45	80	6,0	8,0	11,00	26,5	6,36
UPN 100	10,6	50	100	6,0	8,5	13,50	41,2	8,49
UPN 120	13,4	55	120	7,0	9,0	17,00	60,7	11,12
UPN 140	16,0	60	140	7,0	10,0	20,40	86,4	14,8
UPN 160	18,8	65	160	7,5	10,5	24,00	116	18,3
UPN 180	22,0	70	180	8,0	11,0	28,00	150	22,4
UPN 200	25,3	75	200	8,5	11,5	32,20	191	27,0
UPN 220	29,4	80	220	9,0	12,5	37,40	245	33,6
UPN 240	33,2	85	240	9,5	13,0	42,30	300	39,6
UPN 260	37,9	90	260	10,0	14,0	48,30	371	47,7
UPN 280	41,8	95	280	10,0	15,0	53,30	448	57,2
UPN 300	46,2	100	300	10,0	16,0	58,80	535	67,8
UPN 320	59,5	100	320	14,0	17,5	75,80	679	80,6
UPN 350	60,6	100	350	14,0	16,0	77,30	734	75,0
UPN 380	63,1	102	380	13,5	16,0	80,40	829	78,7
UPN 400	71,8	110	400	14,0	18,0	91,50	1020	102

DIN 1026-1: 2000, NF A 45-202: 1986
 EN 10279: 2000 (Tolerances)
 EN 10163-3: 2004, class C, subclass 1 (Surface condition)
 STN 42 5550
 ČTN 42 5550
 TDP: STN 42 0135

Trare çeliku IPE

IPE beams

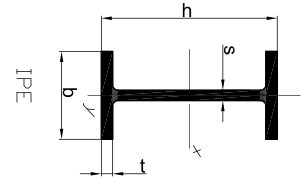

IPE	Dimensions (mm)					Section F	Resistance Moment (cm ³)	
	Weight (kg/m)	b	h	s	t	cm ²	W _x	W _y
IPE 80	6,0	46	80	3,8	5,2	7,64	20,0	3,69
IPE 100	8,1	55	100	4,1	5,7	10,30	34,2	5,79
IPE 120	10,4	64	120	4,4	6,3	13,20	53,0	8,65
IPE 140	12,9	73	140	4,7	6,9	16,40	77,3	12,3
IPE 160	15,8	82	160	5,0	7,4	20,10	109,0	16,7
IPE 180	18,8	91	180	5,3	8,0	23,90	146,0	22,2
IPE 200	22,4	100	200	5,6	8,5	28,50	194,0	28,5
IPE 220	26,2	110	220	5,9	9,2	33,40	252,0	37,3
IPE 240	30,7	120	240	6,2	9,8	39,10	324,0	47,3
IPE 270	36,1	135	270	6,6	10,2	45,90	429,0	62,2
IPE 300	42,2	150	300	7,1	10,7	53,80	557,0	80,5
IPE 330	49,1	160	330	7,5	11,5	62,60	713,0	98,5
IPE 360	57,1	170	360	8,0	12,7	72,70	904,0	123,0
IPE 400	66,3	180	400	8,6	13,5	84,50	1160,0	146,0
IPE 450	77,6	190	450	9,4	14,6	98,82	1500,0	176,4
IPE 500	90,7	200	500	10,2	16,0	115,50	1930,0	214,2
IPE 550	106,0	210	550	11,1	17,2	134,40	2440,0	254,1
IPE 600	122,0	220	600	12,0	19,0	156,00	3070,0	307,9

DIN 1025

Euronorm 19-57 (Dimension)

EN 10034: 1993 (Tolerances)

EN 10163-3, C (Surface conditions)

STN 42 5550

ČSN 42 5550

TDP: STN 42 0135



Trare çeliku HEA

HEA beams

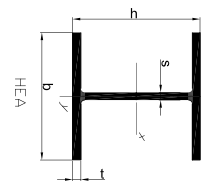

HEA	Dimensions (mm)					Section F	Resistance Moment (cm ³)	
	Weight (kg/m)	b	h	s	t	cm ²	W _x	W _y
HEA 100	16,7	100	96	5	8	21,2	72,76	26,76
HEA 120	19,9	120	114	5	8	25,3	106,3	38,48
HEA 140	24,7	140	133	5,5	8,5	31,4	155,4	55,62
HEA 160	30,4	160	152	6	9	38,8	220,1	76,95
HEA 180	35,5	180	171	6	9,5	45,3	293,6	102,7
HEA 200	42,3	200	190	6,5	10	53,8	388,6	133,6
HEA 220	50,5	220	210	7	11	64,3	515,2	177,7
HEA 240	60,3	240	230	7,5	12	76,8	675,1	230,7
HEA 260	68,2	260	250	7,5	12,5	86,8	836,4	282,1
HEA 280	76,4	280	270	8	13	97,3	1013	340,2
HEA 300	88,3	300	290	8,5	14	112,5	1260	420,6
HEA 320	97,6	300	310	9	15,5	124,4	1479	465,7
HEA 340	105	300	330	9,5	16,5	133,5	1678	495,7
HEA 360	112	300	350	10	17,5	142,8	1891	525,8
HEA 400	125	300	390	11	19	159,0	2311	570,9
HEA 450	140	300	440	11,5	21	178,0	2896	631,0
HEA 500	155	300	490	12	23	197,5	3550	691,1
HEA 550	166	300	540	12,5	24	211,8	4146	721,3
HEA 600	178	300	590	13	25	226,5	4787	751,4
HEA 650	190	300	640	13,5	26	241,6	5474	781,6
HEA 700	204	300	690	14,5	27	260,5	6241	811,9
HEA 800	224	300	790	15	28	285,8	7682	842,6
HEA 900	252	300	890	16	30	320,5	9485	903,2
HEA 1000	272	300	990	16,5	31	346,8	11190	933,6

DIN 1025
Euronorm 53-62 (Dimension)
EN 10034: 1993 (Tolerance)
EN 10163-3, C (Surface)

STN 42 5550
ČSN 42 5550
TDP: STN 42 0135



Trare çeliku HEB

HEB beams

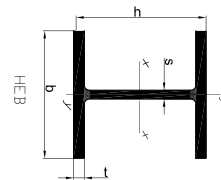

HEB	Dimensions (mm)					Section F	Resistance Moment (cm ³)	
	Weight (kg/m)	b	h	s	t	cm ²	W _x	W _y
HEB 100	20,4	100	100	6	10	26,0	89,91	33,45
HEB 120	26,7	120	120	6,5	11	34,0	144,1	52,92
HEB 140	33,7	140	140	7	12	43,0	215,6	78,52
HEB 160	42,6	160	160	8	13	54,3	311,5	111,2
HEB 180	51,2	180	180	8,5	14	65,3	425,7	151,4
HEB 200	61,3	200	200	9	15	78,1	569,6	200,3
HEB 220	71,5	220	220	9,5	16	91,0	735,5	258,5
HEB 240	83,2	240	240	10	17	106,0	938,3	326,9
HEB 260	93	260	260	10	17,5	118,4	1148	395,0
HEB 280	103	280	280	10,5	18	131,4	1376	471,0
HEB 300	117	300	300	11	19	149,1	1678	570,9
HEB 320	127	300	320	11,5	20,5	161,3	1926	615,9
HEB 340	134	300	340	12	21,5	170,9	2156	646,0
HEB 360	142	300	360	12,5	22,5	180,6	2400	676,1
HEB 400	155	300	400	13,5	24	197,8	2884	721,3
HEB 450	171	300	450	14	26	218,0	3551	781,4
HEB 500	187	300	500	14,5	28	238,6	4287	841,6
HEB 550	199	300	550	15	29	254,1	4971	871,8
HEB 600	212	300	600	15,5	30	270,0	5701	902,0
HEB 650	225	300	650	16	31	286,3	6480	932,3
HEB 700	241	300	700	17	32	306,4	7340	962,7
HEB 800	262	300	800	17,5	33	334,2	8977	993,6
HEB 900	291	300	900	18,5	35	371,3	10980	1050
HEB 1000	314	300	1000	19	36	400,0	12890	1085

DIN 1025
Euronorm 53-62 (Dimension)
EN 10034: 1993 (Tolerance)
EN 10163-3, C (Surface)

STN 42 5550
ČSN 42 5550
TDP: STN 42 0135

Trare çeliku IPN

IPN beams

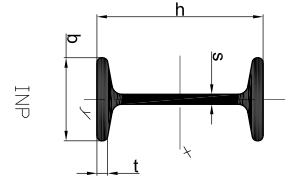

IPN	Dimensions (mm)					Section F	Resistance Moment (cm ³)	
	Weight (kg/m)	b	h	s	t	cm ²	W _x	W _y
IPN 80	5,94	42	80	3,9	5,9	7,57	19,5	3,00
IPN 100	8,34	50	100	4,5	6,8	10,6	34,2	4,88
IPN 120	11,1	58	120	5,1	7,7	14,2	54,7	7,41
IPN 140	14,3	66	140	5,7	8,6	18,2	81,9	10,7
IPN 160	17,9	74	160	6,3	9,5	22,8	117	14,8
IPN 180	21,9	82	180	6,9	10,4	27,9	161	19,8
IPN 200	26,2	90	200	7,5	11,3	33,4	214	26,0
IPN 220	31,1	98	220	8,1	12,2	39,5	278	33,1
IPN 240	36,2	106	240	8,7	13,1	46,1	354	41,7
IPN 260	41,9	113	260	9,4	14,1	53,3	442	51,0
IPN 280	47,9	119	280	10,1	15,2	61,0	542	61,2
IPN 300	54,2	125	300	10,8	16,2	69,0	653	72,2
IPN 320	61,0	131	320	11,5	17,3	77,7	782	84,7
IPN 340	68,0	137	340	12,2	18,3	86,7	923	98,4
IPN 360	76,1	143	360	13,0	19,5	97,0	1090	114
IPN 380	84,0	149	380	13,7	20,5	107,0	1260	131
IPN 400	92,4	155	400	14,4	21,6	118,0	1460	149
IPN 450	115	170	450	16,2	24,3	147,0	2040	203
IPN 500	141	185	500	18,0	27,0	179,0	2750	268
IPN 550	166	200	550	19,0	30,0	212,0	3610	349
IPN 600	199	215	600	21,6	32,4	254,0	4630	434

DIN 1025-1: 1995

EN 10024: 1995 (Tolerances)

EN 10163-3: 2004 (Surface conditions)

STN 42 5550

ČTN 42 5550

TDP: STN 42 0135



 albsteel





Rruga "Rrapeve", Km. 3, Xhafzotaj, Durrës, Albania

T +355 52 901061 / +355 52 901062 / M +355 68 2088061 / +355 68 2088063

info@albsteel.al / sales@albsteel.al www.albsteel.al